

CONTEC

CT 250 / CT 350

Instruction manual
Betriebsanleitung
Instructions techniques



Index

1. EU-Declaration of Conformity	...3
2. Technical Data	...4
2.1 Planer	...4
2.2 Tools	...4
3. Applications of the tools	...5
4. Safety rules	...5
5. Operating	...6
6. Changing the drum	...6
7. Adjusting the drum	...7
8. Maintenance and cleaning	...8
8.1 Bearings	...8
8.2 Height adjustment and joints	...8
8.3 Belt drive	...8
8.4 Cleaning	...8
9. Diagram	...8
10. Appendix	...8

CONTEC GmbH

Hauptstrasse 146
57518 Alsdorf

1 EU-Declaration of Conformity

According to the Machine Directive 98/37/EC (89/392/EWG), Appendix II A

We hereby declare that the machine

Type: Floor Planer
Name: CT 250, CT 350

conforms with the following standards which have been valid at the date written below:

EC-Directive 98/37/EC (89/392/EEC), in its current wording
EC-Directive 89/336/EEC, in its current wording
EC-Directive 73/23/EWG (89/392/EEC), in its current wording

List of the essential harmonised standards:

EN 12100	„Safety of machines
EN 418	„Emergency-Stop-Devices“
EN 953	„Separating safety devices“
EN 60204 Part 1	„Electric equipment of machinery, general requirements“
EN 1050	„Guiding principles for the risk judgement“

Alsdorf, 10.04.2004

(Place and date)



(Authorized signature)

J. Greb – Construction department

(Name and function of the authorized person)

2. Technical Data

2.1 Planer

	CT 250	CT 350
Width of cut	250 mm	350 mm
Width	44 cm	59 cm
Length	104 cm	103 cm
Height	99 cm	97 cm
Weight	135 kg	150 kg
Dust port \varnothing	70 mm	70 mm
Height Adjustment	Hand wheel and lever	Hand wheel and lever
Vibration damped handle	Rubber block on Handle bracket	Rubber block on Handle bracket
Electric motor	400 V/480V, 7.5 kW	400 V/480V, 7.5 kW
Honda petrol	9 hp	11 hp
Other Motors	On request	On request
Average value of acceleration a_{hv} *	8,6 m/s ²	5,1 m/s ²
Noise level L_{wa} *	109 dB(A)	109 dB(A)
Noise level Leq *	96 dB(A)	97 dB(A)

* Data: VÜA Verein zur Überwachung technischer Anlagen e.V.

2.2 Tools

	CT 250	CT 350
Drum \varnothing	180 mm	130 mm
Cutter shaft \varnothing	16 mm	12 mm
Number of shafts	6	6
TCT Cutter	57/6	46/5
Milling cutter	57/20	46/20
Beam flails	57	46
Cutter \varnothing	57	46
Number of TCT Cutters	132	216
Number of milling cutters	48	54
Number of beam flails	540	858

All specifications are approximate and subject to confirmation. They should only be used as a guide.

3. Applications of the tools

TCT Cutters	Heavy duty, long life cutters for all concrete texturing, scabbling, planing and grooving applications. Also used for removal of road markings, roof chippings and brittle coatings
Milling cutters	Primarily for the removal of thermoplastic road / runway markings. Tipped with tungsten carbide they are cost effective and highly efficient. A range of cutter dimensions are available.
Beam flails	Heat treated cutters for the removal of paint coatings and laitance from new concrete. Also for removing grease, dirt and ice deposits.

4. Safety rules

Attention ! The CT 250 and CT 350 floor planers are constructed according to existing safety rules and regulations. These technical precautions should not be removed or changed under any circumstances. While operating the machines the following items should also be kept in mind:

1. The planers should always be operated with all safety covers and technical precautions.
2. The operator should never leave the machine during operation.
3. Before leaving the machine all rotary parts should be brought to a stand still. The electric models must be disconnected from the mains. Make sure that the machine cannot roll or move by itself.
4. After maintenance and adjustment all safety covers must be reattached.
5. If the noise level exceeds 90 dB(A) ear protectors must be worn.
6. In the event of a large amount of dust during operation connect a dust collector to the planer.

5. Operating

- a. After mounting the appropriate tools the operation of the planer can begin.
- b. The lever of the height adjustment (Appendix diagram No. 97 and 99) has to be in the upper position before the machine is switched on. The hand wheel of the height adjustment must also be turned anti-clockwise as far as possible.
- c. Switch the motor on. Lower the planer with the lever to the operating position. Turn the hand wheel of the height adjustment until the tools are lowered to the floor and until you achieve the required finish.

Attention: Lowering the tools too much decreases the performance of the machine. You will also destroy the shafts in the drum and the bearings of the machine.

Attention: Never switch the motor of the planer on while the tools still touch the floor. Always lift the machine and the tools clear from the floor and then switch the motor on.

- d. Heavy dust can be avoided by connecting a dust collector to the dust port.
- e. The vibration damped handle bar ensures an easier operation.

6. Changing the drum

Attention: Before any maintenance, the machine must be brought to a complete stand still. Always disconnect the machine if it is an electric model.

- Lift the machine with the hand wheel so that the tools are well clear of the floor.
- Unscrew the screws on the right side plate (M10, Key width 17 mm)
- Carefully remove the side plate.
- Take out the drum. Remove worn out tools. Check shafts and drums concerning wear and tear. If necessary replace new tools on the drum.
- Push drum on freshly greased shaft.
- Reconnect right side plate.

7. Adjusting the drum

During the operation of the CT 250 and CT 350 floor planers or after a drum has been changed or replaced, the drum shaft and the rear wheel axis can fall out of alignment. This results in an uneven track on the floor. On one side the drum touches the floor before the other and therefore removes more surface material on this side.

The two rear wheels are mounted on an eccentric shaft (see diagram).

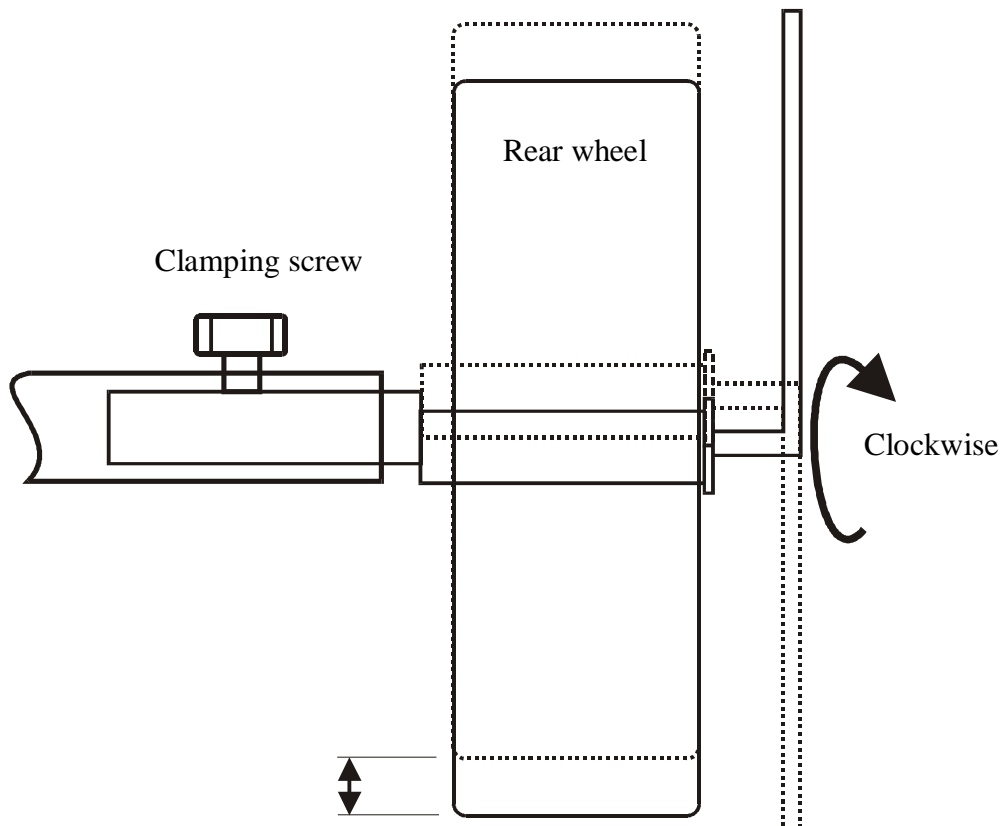

If the drum has to be adjusted proceed as follows:

Place the planer on an even floor. Lift the machine with the height adjustment hand wheel, until all the tools are well clear of the floor. Loosen the clamping screw of the eccentric shaft. On the other side of the rear wheel is a screw which keeps the wheel on the shaft. Turning the screw will also turn the eccentric shaft. The floor planer moves up and down on one side. Always turn the screw clockwise. Anti clockwise would loosens the screw. Keep turning until all the tools on the drum are the same distance to the floor. Tighten the clamping screw again.

8. Maintenance and cleaning

8.1 Bearings

All bearings are greased for their life time.

8.2 Height adjustment and joints

All joints have to be greased periodically with a standard machine grease.

8.3 Belt drive

Check the belt after approximately every 30 hours of operation. For tensioning the belt you need to change the position of the belt tensioner wheel underneath the belt cover.

8.4 Cleaning

A regular cleaning of the machine increases the life of all components and tools of the planer.

9. Diagrams

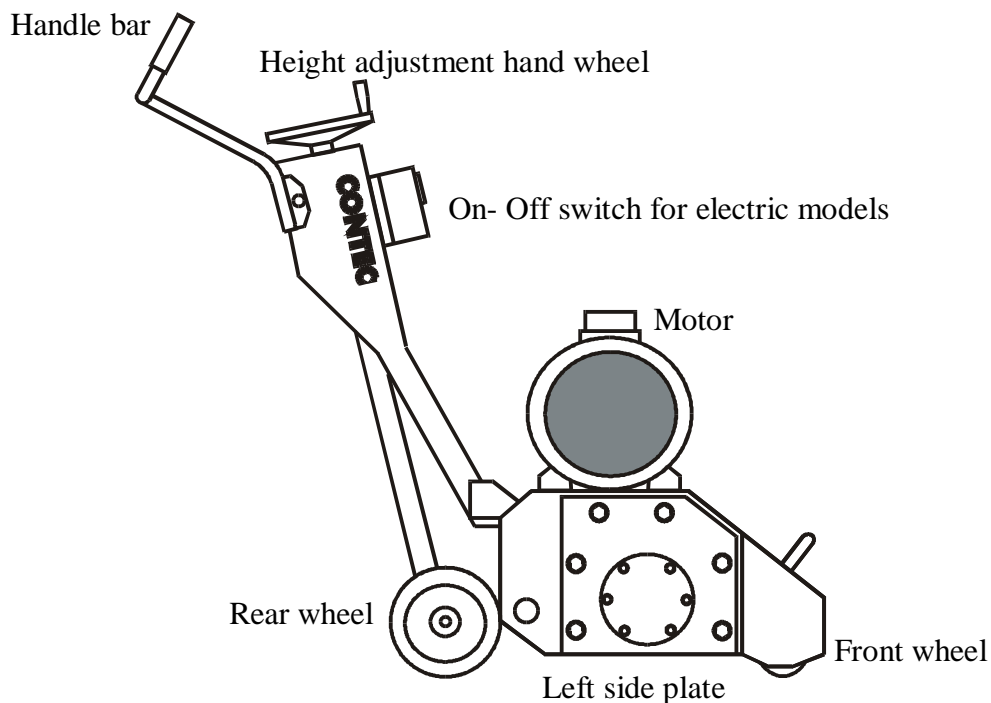

10. Appendix

Diagrams
Wire diagram
Tools
Part list

CT 250 - 400 V, 50 HZ
(c) Contec GmbH 2003

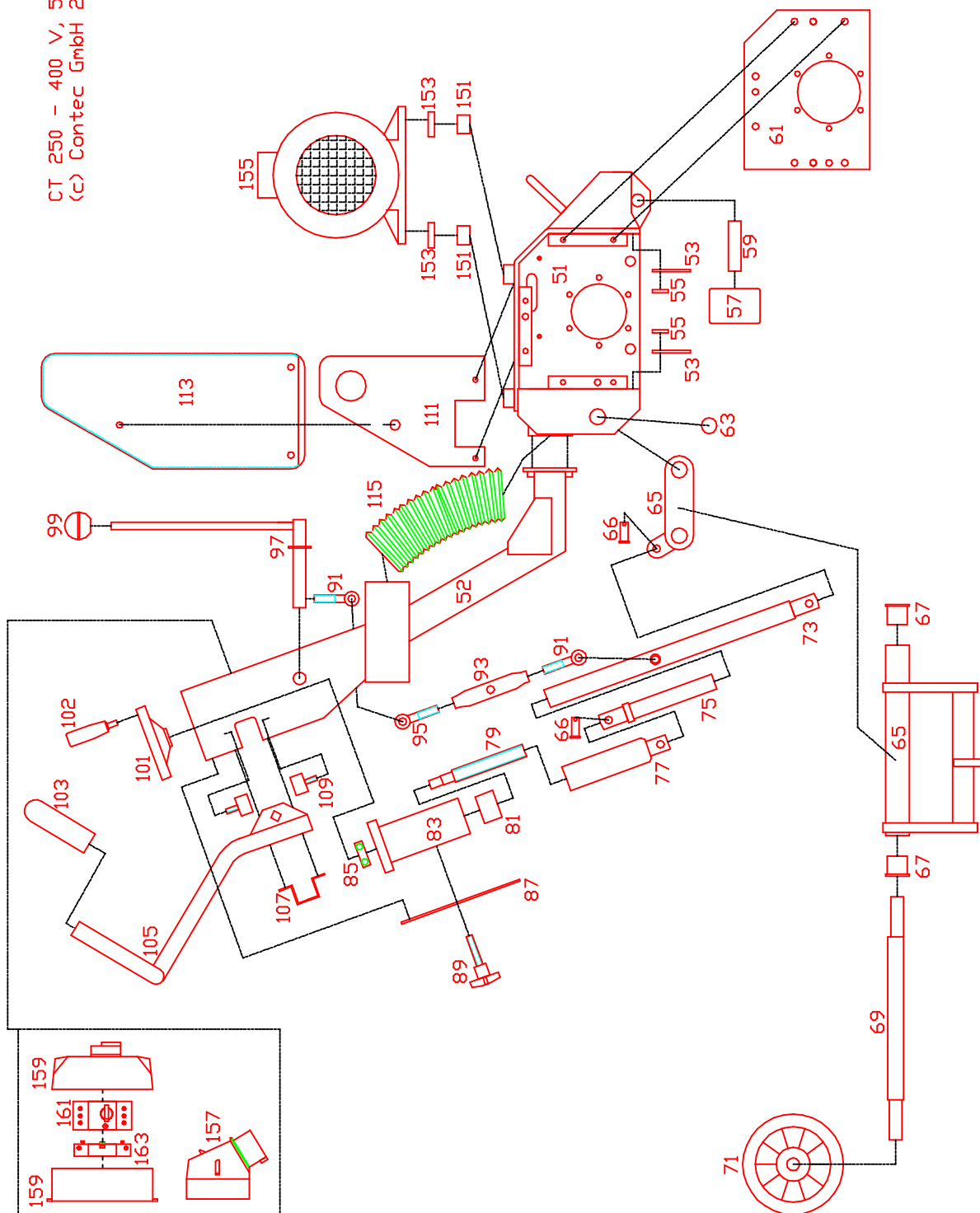

CT 350 - 400 V, 50 Hz
(c) Contec GmbH 2005

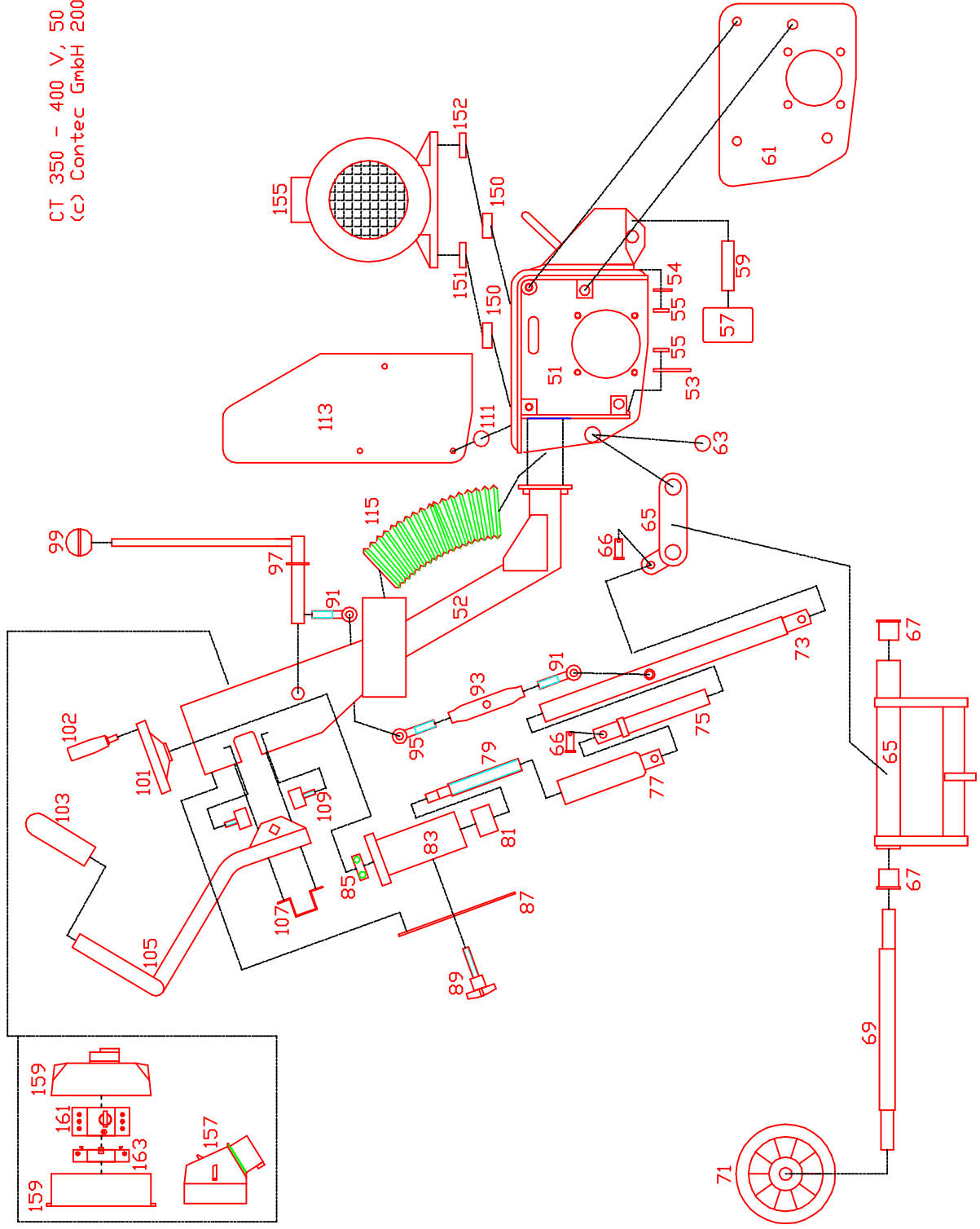

CT 250 - Honda
(c) Contec GmbH 2003

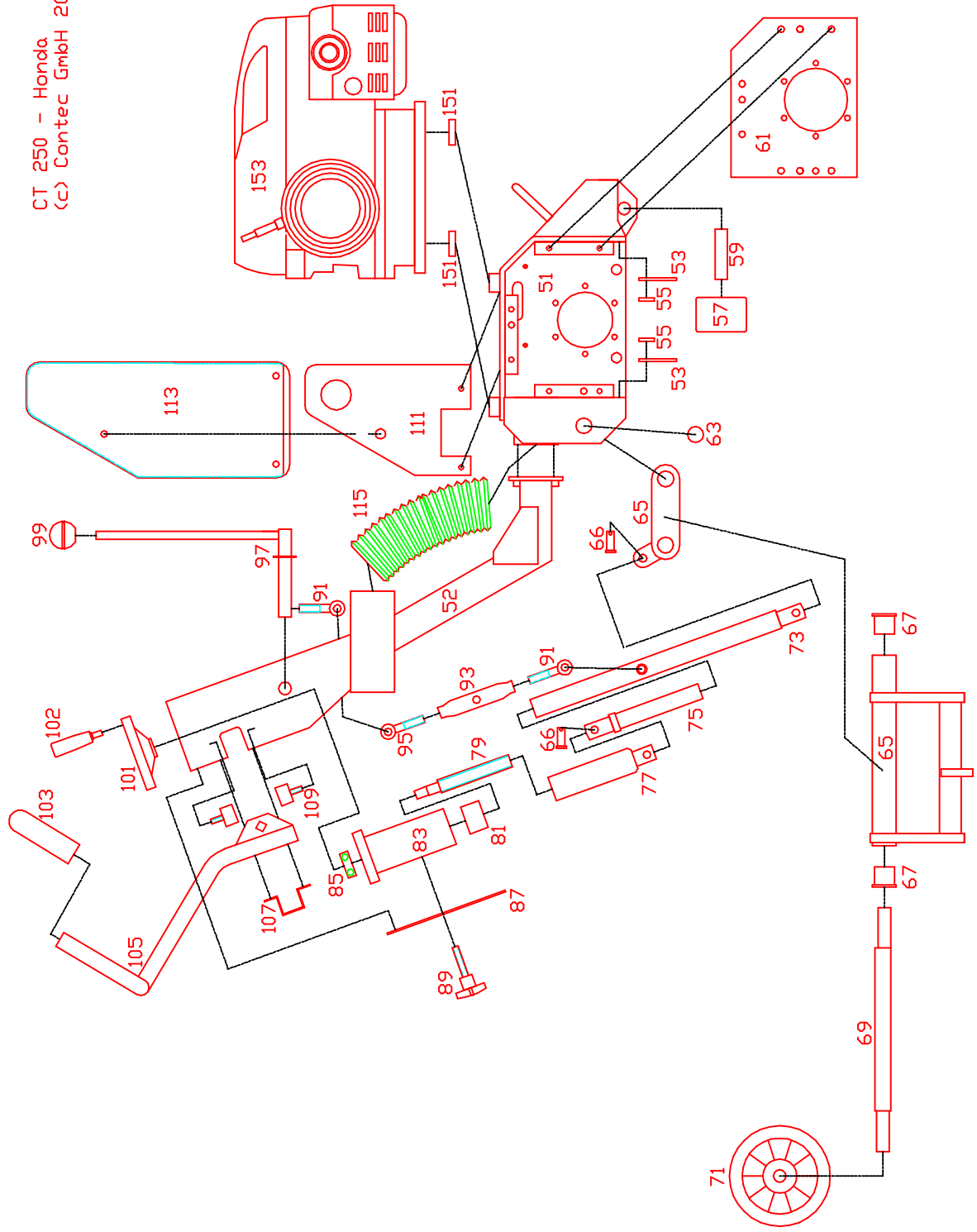

CT 350 - Honda
(c) Contec GmbH 2004

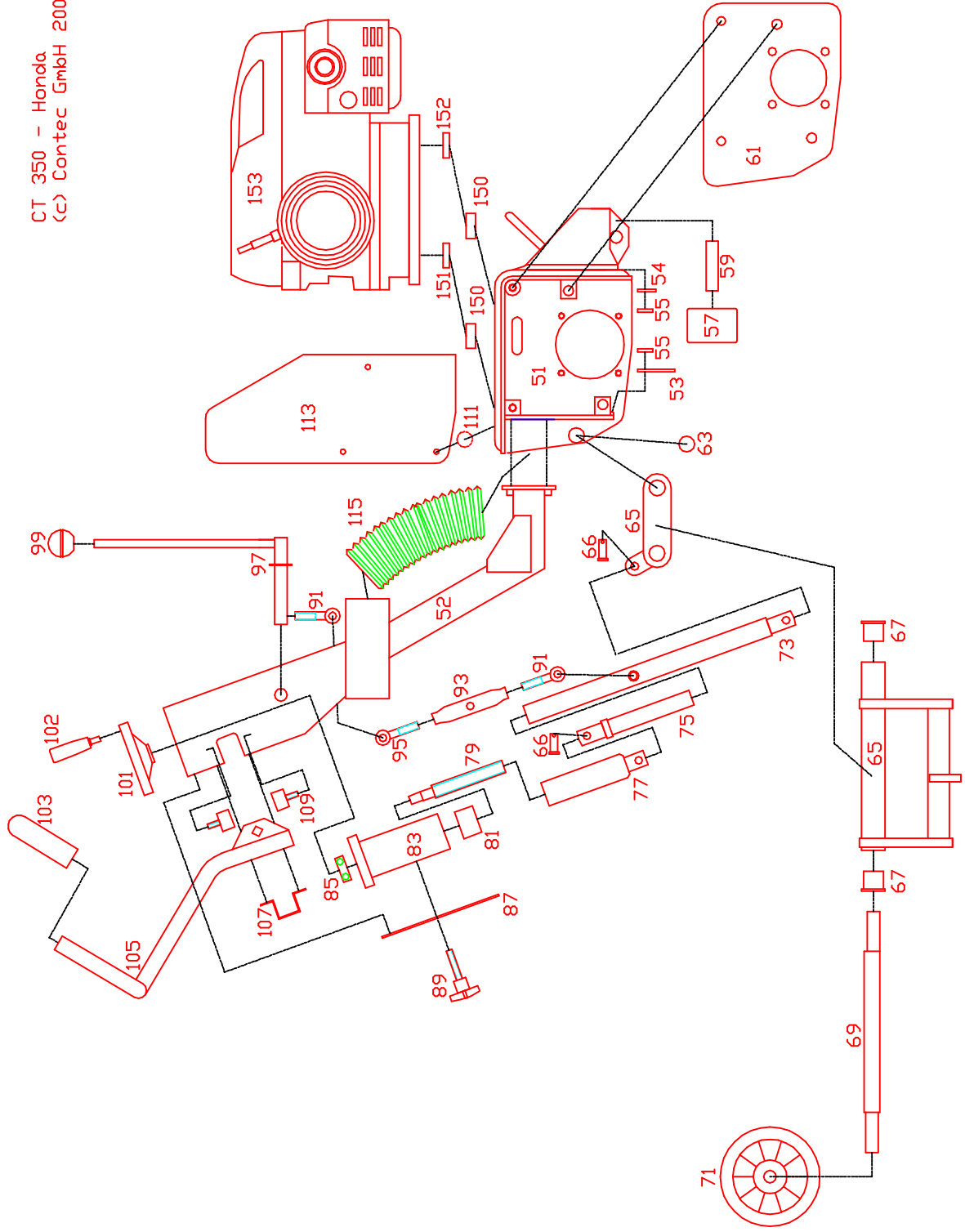

CT 250 Riementrieb und Trommelwelle /
Belt drive and shaft
(c) Contec GmbH 2003

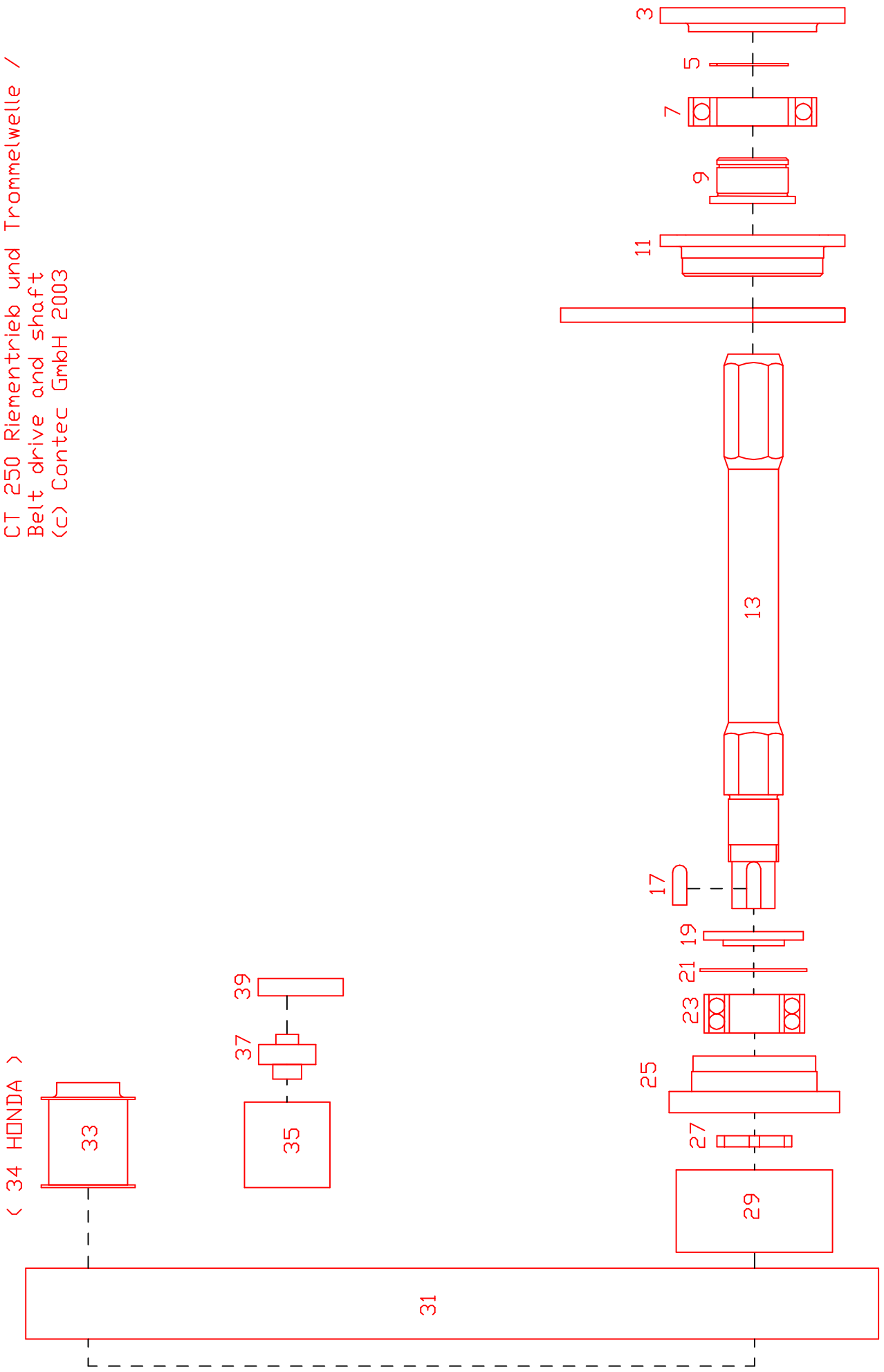

CT 350 Riementrieb und Trommelwelle /
Belt drive and shaft
(c) Contec GmbH 2003

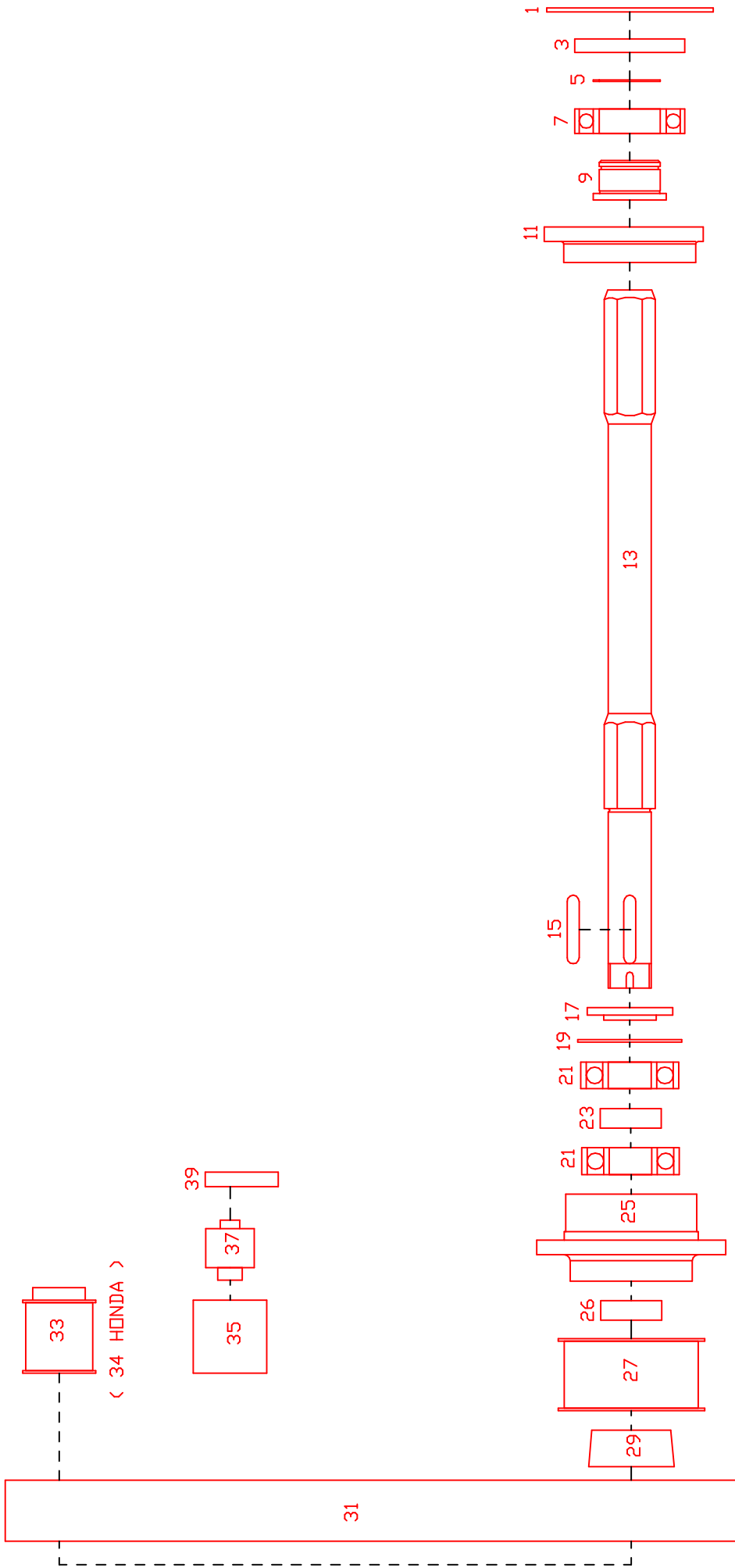

CT 250 / 350 400 V, 50 Hz

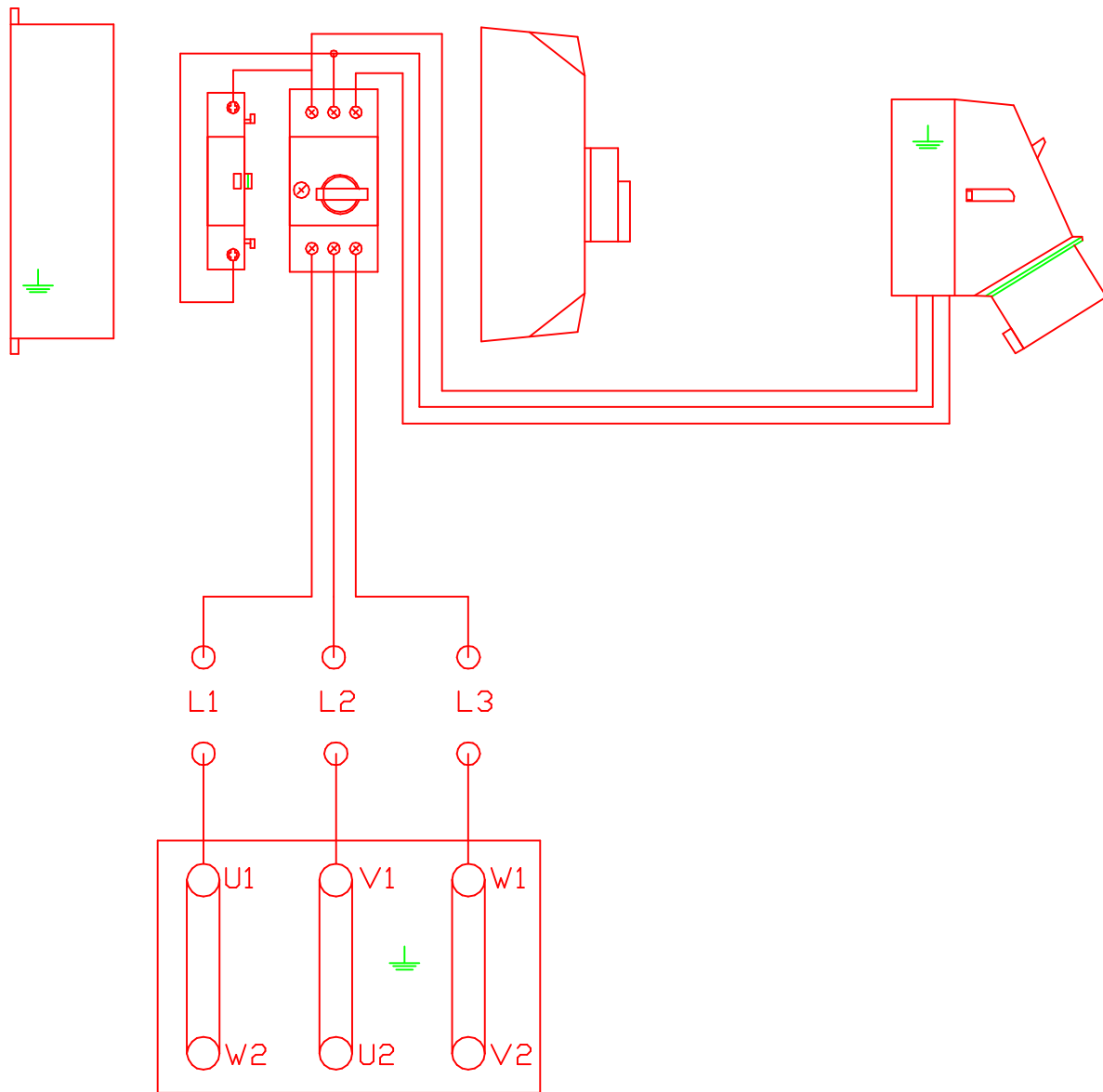

Motor клеммkasten
Motor Connection Board

<Verwendungsbereich> CT 250 / 350 400 V, 50 Hz		<Zul.Abw.>	<Oberfl.>	Masstab	<Gewicht>
				Werkstoff	
		Datum	Name	<Benennung>	
		Bear. 13.11.03	Greb	Verdrahtung	
		Gepr.			
		Norm			
		Firma		<Zeichnungsnummer>	Blatt
		CONTEC GmbH			
		57518 Alsdorf			Bl.
Zust.	Änderung	Datum	Name	<Urspr.i>	<Ers.f.i> <Ers.d.i>

Werkzeuge für CT 250
 Tools for CT 250
 (c) Contec GmbH 2003

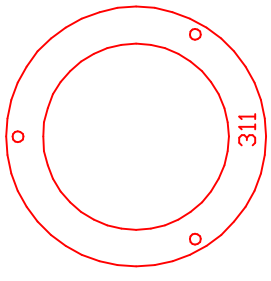
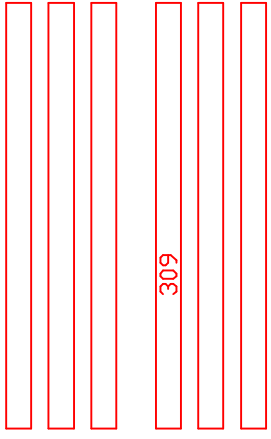
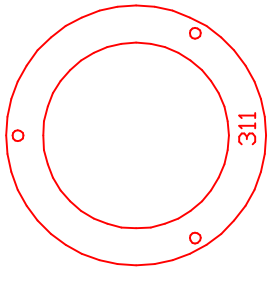

300 Trommel / drum

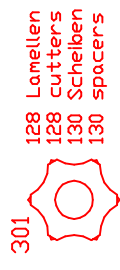

301
 128 Lamellen
 128 cutters
 130 Scheiben
 130 spacers



307



303
 36 Lamellen
 36 cutters
 120 Scheiben
 120 spacers



307



305
 144 Lamellen
 144 cutters
 144 Scheiben
 144 spacers

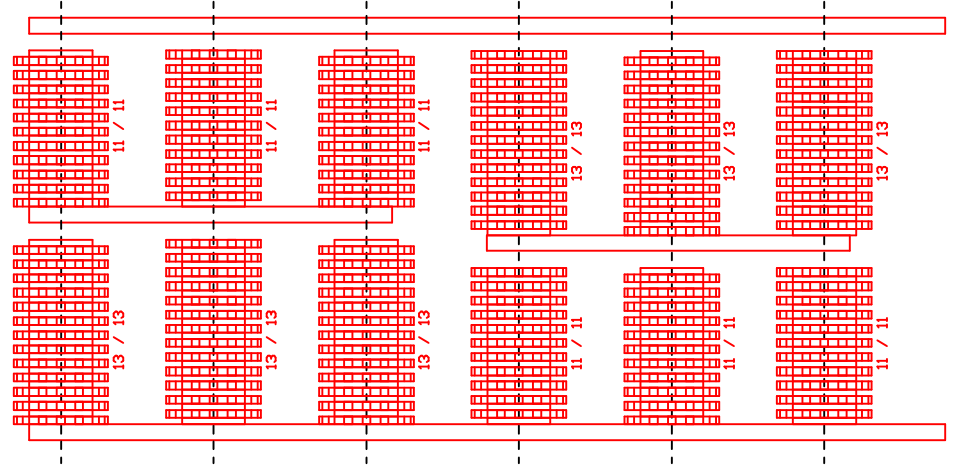
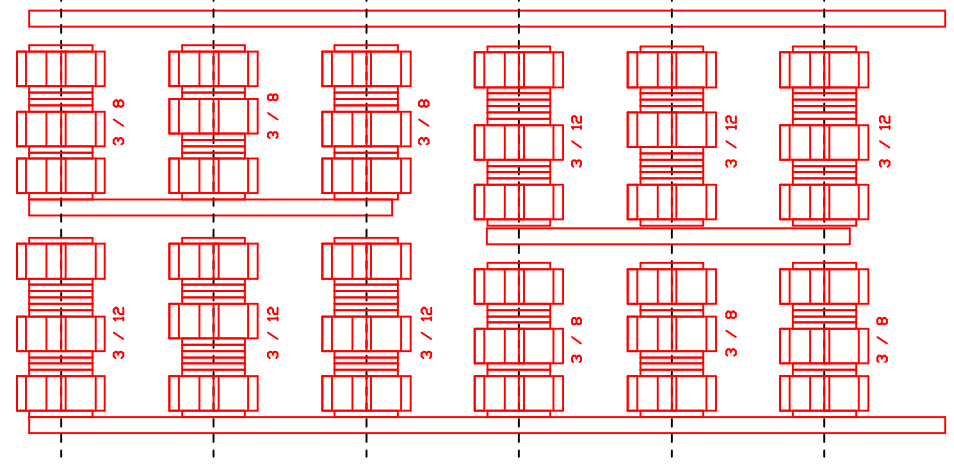
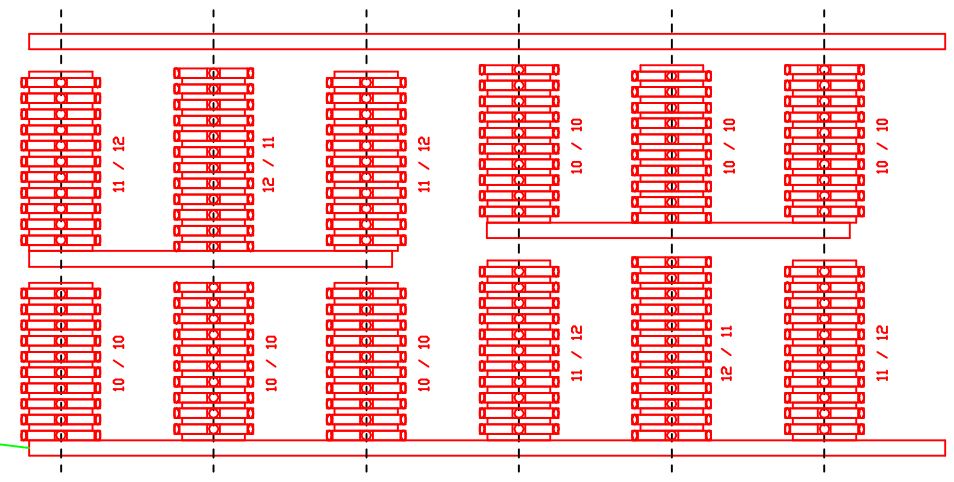

Werkzeuge für CT 350
 Tools for CT 350
 (c) Contec GmbH 2004

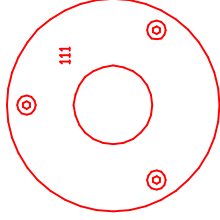
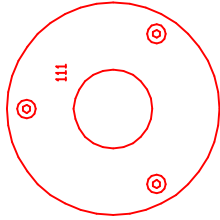
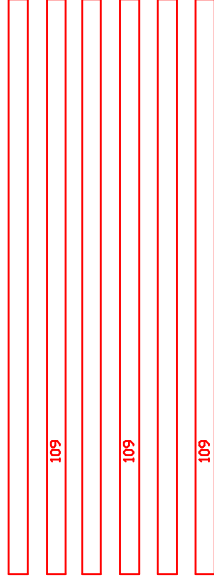

101 216 Lamellen /
 216 cutters
 216 Schelben /
 216 spacers



103 48 Schällamellen /
 48 milling flails
 264 Schelben /
 264 spacers



105 96 Schällamellen /
 96 milling flails
 264 Schelben /
 264 spacers

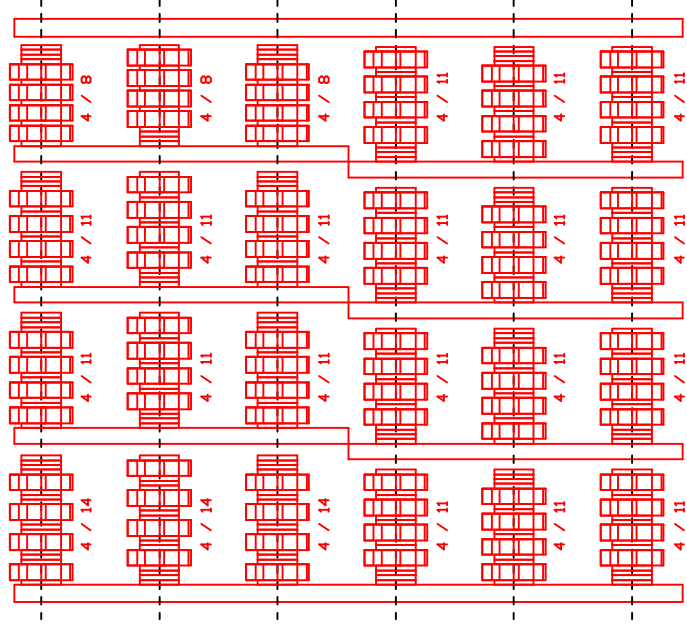
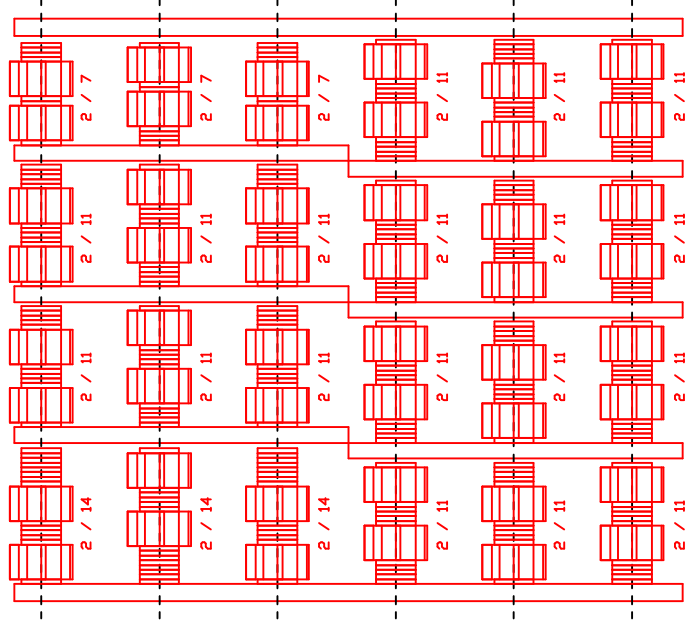
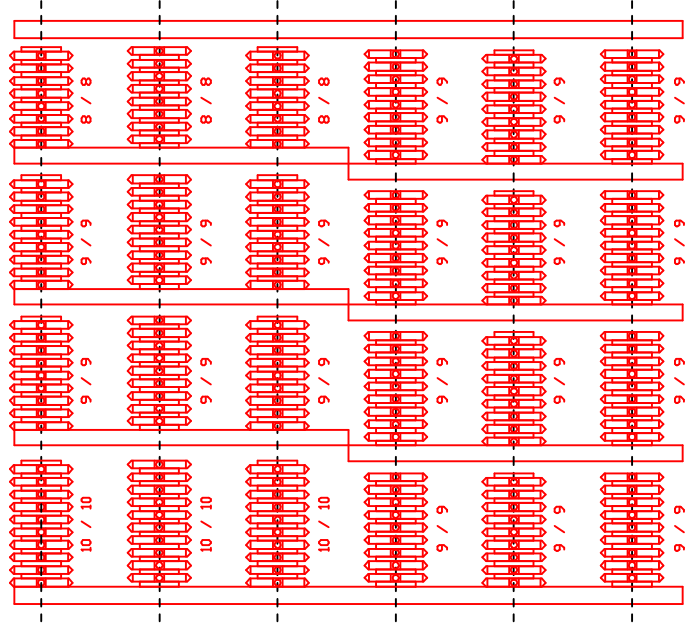

CT 250 Stückliste / Parts List

Artikel-Nr. / Part-No.	Description 1	Description 2	D-Nr	Weight KG
19-10-07-03	Cover Support Bearing Housing CT250		3	0,88
61-30-00-47	Circlip for right side Bearing Housing	CT250/CT350	5	0,01
61-20-62-10	Bearing for right Bearing Housing CT250/	CT350	7	0,48
19-21-07-06	Hexagon Insidering Bearing Housing	Main Axis CT250/350	9	0,24
19-10-07-04	Bearing Housing Support CT250		11	0,72
19-21-07-05	Drive Shaft CT250		13	3,08
19-10-07-01	Drive Bearing Housing Spacer CT250/CT350	between Bearing and Drum	19	0,15
61-30-01-70	Circlip for left side Bearing Housing	CT250	21	0,02
61-20-32-07	Bearing for Drive Side CT250		23	0,43
19-10-07-02	Drive Bearing Housing CT250		25	1,20
19-21-07-07	Nut on Drive Shaft CT 250		27	0,12
70-44-8M-50	Pulley Drum CT 250		29	2,49
70-24-08-80	Belt CT250/CT350		31	0,25
70-22-8M-50-US	Motor pulley CT 250/350 USA Version		33	0,70
70-24-8M-50	Pulley Motor CT 250		33	0,94
70-24-8M-50-H	Motor pulley CT 250 Honda 9 HP		34	1,00
70-26-27-00	Spanner for Belt CT250/CT350		35	0,39
19-10-12-04	Inside Idler-Mtg. Bush CT250		37	0,15
19-10-01-00	Main Chassis Housing CT250		51	0,00
19-10-02-00	Machine Arm CT250		52	0,00
70-24-16-60	Rubber Sealing rear CT 250		53	0,10
19-10-13-01	Bracket for Rupper Sealing front/rear	CT 250	55	0,25
80-20-80-60	Front Wheel CT250/350		57	0,89
19-10-01-07	Front Axle CT250/CT350		59	0,18
19-10-04-05	Main Axle for Swingarm CT 250		63	1,25
19-10-04-00	Swing Arm for rear Axis CT250/350		65	0,00
60-33-12-25	Connecting Pin for lifting Rod CT250/350		66	0,00
61-24-50-30	Axis Height Adjustment Bronze Bearing	CT250/CT350	67	0,06
19-10-04-06	Rear Axis with Excenter CT250		69	1,30
80-20-31-60	Rear Wheel CT250/CT350		71	1,14
19-10-05-05	Lifting Rod long CT 250		73	0,83
19-10-05-06	Lifting Rod short CT 250/CT350		75	0,33
19-10-05-03	Height Control Actuating Rod CT250/CT350		77	0,81
19-10-05-02-C	Height Adjustment Screw CT250/350		79	0,29

CT 250 Stückliste / Parts List

61-24-40-46	Height Adjustment Bronze Bearing	CT250/CT350	81	0,08
19-10-05-01	Housing for Height Control CT250/CT350		83	2,03
61-20-63-02	Bearing for Lift Tube CT250/CT350		85	0,09
19-10-02-07	Rear Cover Machine at the Handle	CT250/CT350	87	0,75
61-50-12-60	Eye Srew right turn Lift CT250/CT350		91	0,08
19-10-05-07	Connection for Eyescrew CT 250/CT350		93	0,22
61-50-12-60-L	Eye Srew left turn Lift CT250/CT350		95	0,08
19-10-05-08	Lever CT 250/CT350		97	0,66
90-21-45-12	Golf Ball CT250/350		99	0,07
90-21-95-50	Level Adjustment Wheel CT250/CT350		101	0,38
90-21-95-51	Revolving Pin for Handwheel CT 250		102	0,08
70-21-26-10	Rubber Grip CT 250		103	0,06
19-10-03-01	Handle with flexible Rubber Block	CT250/350	105	4,00
70-26-18-00	Plate to fasten Rubber Block for Handle	CT250/CT350	107	0,08
70-26-30-00	Vibration blocks CT250/350		109	0,05
19-10-06-01	Rear Plate Belt Cover CT250		111	0,66
19-10-06-03	Belt Cover CT250		113	0,00
70-25-02-70	Dusthose at the Machine 70 mm Diameter	Black Colour CT250/CT350	115	0,35
19-10-12-06-H	Bracket for Petrol Motor rear CT 250		151	0,68
19-10-12-06-V	Bracket for Petrol Motor front CT 250		151	0,71
19-10-12-08	Distance Ring Motor Bracket CT 250		151	0,00
19-10-12-05	Bracket for Electric Motor front/rear	CT 250	153	0,70
19-10-12-06-US-H	Motor mounting Plate rear CT 250 for	Baldor 10 HP Motor US	153	0,78
19-10-12-06-US-V	Motor mounting Plate front CT 250 for	Baldor 10 HP Motor US	153	0,94
56-GX-270-4	Motor 9HP for CT250/CT350		153	0,00
55-03-00-75	Motor 7,5 KVA, 400 Volt CT250/CT350		155	44,00
55-13-00-75	Motor 7,5 KVA, 200 Volt, 3 Phase Japan	CT250/CT350	155	44,00
51-10-10-00	Switch Box For Motor Protective	CT250/350	159	0,51
51-20-30-01	Motor Protective 7,5 KVA, 400 Volt	CT 250/350	161	0,31
51-20-30-03	Low Voltage Protective 400 V CT250/350		163	0,00
19-10-27-00	Lever CT 250/CT350 with Drive Unit		171	0,70
61-50-10-40	Eye Scrw for Quick Lever CT 250 with	Drive	173	0,04
19-10-28-00	Upper Lifting Rod CT 250 with Drive Unit		175	0,70
19-10-28-01	Lower Lifting Rod CT 250 with Drive Unit		177	0,70
974-10-40	Long Nut Lifting Rod CT 250 with Drive		179	0,08
50-20-20-17	Drive Unit Motor with Gearbox 170 Watt	complete CT 250	181	6,40

CT 250 Stückliste / Parts List

19-10-08-00	Lifting Tube with Motor Mounting CT 250		183	0,00
19-10-09-00	Tube for Drive at Swing Arm CT250/CT350		185	0,00
80-20-31-00	Drive Wheel CT250/CT350		187	0,00
19-10-20-01	Drive Axis CT 250/CT350		191	0,00
6885-40-6-7	Key 40 mm CT 250		193	0,00
6885-80-6-7	Key 80 mm CT 250		195	0,00
50-20-16-01	Reverse Plug CT250/350		221	0,00
50-20-23-03	Direction Switch CT 250 with Drive		223	0,00
50-20-23-09	Mounting Adapter for Switches CT 250	with Drive	225	0,00
50-20-30-16	Potentiometer with Knob CT 250 with	Drive	227	0,00
50-20-23-01	Emergency Switch CT 250 with Drive Unit		229	0,00
50-20-33-07	Contact Element K10 CT 250		231	0,00
50-20-33-08	Contact Element K01 CT 250		233	0,00
50-20-30-15	Drive Circuit CT 250		235	0,00
50-20-40-01	Transformer CT 250		237	3,70
51-10-10-01	Switch Box For Motor Protective CT 250	with drive	239	0,00
50-10-15-03	Electric Box CT 250 with drive Unit		247	0,00
95-16-57-06	Tungston Carbide Cutters 57/6 CT250		301	0,08
95-16-57-20	Milling Flail Cutters 57 / 20 CT250		303	0,30
95-16-57-05	Steel Cutters Beam Flails 57 / 15 CT250		305	0,06
95-16-30-17	Spacer CT250		307	0,03
95-10-250-A	Axis for Drum CT250		309	0,43
95-10-01-00	Drum Bracket for Diamond Tool CT 250		381	32,50
95-21-01-T0	Diamontring 40 mm wide with 18 Segment	Silver CT 250	383	2,80
19-10-02-00-G	Machine Arm CT250 13 HP Drive			0,00
19-10-04-00-G	Swing Arm for rear Axis CT250 13 HP	Drive		0,00
19-10-06-02-G	Bracket for Belt Cover CT 250 Petrol	with Drive		0,00
19-10-20-00	Drive complete for CT 250			15,00
19-10-23-00	Belt Cover CT 250 Petrol 13 HP with	Drive Unit		0,00
19-10-24-00	Rear Plate of Belt Cover CT 250 Petrol	13 HP with Drive		0,00
19-10-25-00	Cover Generator CT 250 Petrol 13 HP with	Drive		0,00
19-10-26-00	Distanz for Honda 13 HP with Drive Unit	CT 250		0,45
50-10-15-03-G	Electric Box CT 250 13 HP with Drive			0,00
50-20-30-63-A	Fuse 6,3 A for control cercuit CT 250			0,00
50-20-30-K	Capacitor CT 250 13 HP with Drive			0,00
51-10-10-19-US	Switch Box For Motor Protective	CT250/350 10 HP 230 Volt US Version		0,00

CT 250 Stückliste / Parts List

51-10-10-20-US	Switch Motor Protective CT250/350	10 HP 230 Volt US Version		0,00
51-10-10-21-US	Motor Protective Switch Button CT250/350	10 HP 230 Volt US Version		0,00
55-03-01-75	Fan for Motor 7,5 KVA, 400 Volt CT250/	CT350		0,00
55-03-02-75	Cover for Fan Motor 7,5 KVA, 400 Volt	CT250/CT350		0,00
55-03-03-75	Bearing plate B side for Motor 7,5 KVA,	400 Volt, CT250/350		0,00
55-03-04-75	Motorfood 7,5 KVA, 400 Volt CT250/350			0,00
56-20-24-00	Generator CT 250 Petrol with Drive Unit			0,00
56-270-10	Key for Motor 9 HP CT250/CT350			0,00
56-270-11	Starter complete for GX 270 CT250/CT350			0,00
56-270-5	Side Exhaust for Motor GX 270 CT250/CT350			0,00
56-390-5	Side Exhaust for Motor GX 390 CT250/CT350			0,00
56-GX-390-4	Motor 13HP for CT250/CT350 Drive Unit	Version		0,00
70-24-10-00	Belt CT250 Petrol with Drive Unit			250,00
70-24-85-00	Belt Motor to Generator CT 250 Honda	13 HP with Generator		62,00
70-24-8M-51-H	Motor pulley CT 250 Honda 13 HP with	Drive Unit		1,00
70-26-18-50	Rubber Block for Handle CT250/CT350			0,25
90-24-00-85	Pully Generator CT 250 13 HP Drive			526,00
90-24-12-10-24	Taper bush CT 250 Generator			0,00
90-24-71-1TB	Pulley Motor to Generator CT 250 Petrol	with Drive		0,00
95-10-250-K	Complete Drum with tipped Tungston Cutter	57/6 CT250		27,30
95-10-250-K-57-20	Complete Drum with tipped Tungston Cutter	57/20 CT250		28,50
95-10-250-T	Drum for CT250			10,40
95-16-30-17-K	Spacer CT250 1 Set = 130 Pieces			3,64
95-16-57-06-132	Set Tungston Carbide Cutters 57/6 CT 250	1 Set = 128 Pieces		9,80
95-16-57-20-36	Set Milling Flail Cutters 57/20 CT250	1 Set = 36 Pieces		10,90

CT 350 Stückliste/Parts List

Artikel-Nr. / Part-No.	Description 1	Description 2	D-Nr	Weight KG
19-10-17-05	Lid for right Bearing Housing CT 350		1	0,38
61-30-00-47	Circlip for right side Bearing Housing	CT250/CT350	5	0,01
61-20-62-10	Bearing for right Bearing Housing CT250/	CT350	7	0,48
19-21-07-06	Hexagon Insidering Bearing Housing	Main Axis CT250/350	9	0,24
19-10-17-04	Right Bearing Housing CT350		11	0,00
19-21-17-06	Drive Shaft CT350		13	4,52
19-10-07-01	Drive Bearing Housing Spacer CT250/CT350	between Bearing and Drum	17	0,15
61-30-01-80	Circlip for left side Bearing Housing	CT350	19	0,03
61-20-63-07-2			21	0,48
19-10-17-03	Drive Bearing Drum Spacer in the left	Bearing Housing 16 mm CT 350	23	0,13
19-10-17-01	Drive Bearing Housing CT350		25	2,83
19-10-17-03-7	Drive Bearing Drum Spacer 7 mm CT350	between Pulley and Bearing Housing	26	0,06
70-44-8M-50-TB			27	1,71
90-24-20-12-35	Taber-lock for 70-44-8M-50 CT350		29	0,60
70-24-08-80	Belt CT250/CT350		31	0,25
70-22-8M-50	Pulley Motor CT 350		33	0,72
70-22-8M-50-H	Motor pulley CT 350 Honda 9 HP		33	0,79
70-22-8M-50-US	Motor pulley CT 250/350 USA Version		33	0,00
70-26-27-00	Spanner for Belt CT250/CT350		35	0,39
19-10-18-01	Inside Idler-Mtg. Bush CT350		37	0,31
19-10-14-00	Main Chassis Housing CT350		51	0,00
19-10-02-00	Machine Arm CT250		52	0,00
70-23-16-60	Rubber Sealing rear CT 350		53	0,10
70-23-16-40	Rubber Sealing front CT 350		54	0,09
19-10-16-01	Bracket for Rupper Sealing front/rear	CT 350	55	0,40
80-20-80-60	Front Wheel CT250/350		57	0,89
19-10-01-07	Front Axle CT250/CT350		59	0,18
19-10-04-05-L	Main Axle for Swingarm CT 350		63	1,26
19-10-04-00	Swing Arm for rear Axis CT250/350		65	0,00
60-33-12-25	Connecting Pin for lifting Rod CT250/350		66	0,00
61-24-50-30	Axis Height Adjustment Bronze Bearing	CT250/CT350	67	0,06
19-10-04-06	Rear Axis with Excenter CT250/CT350		69	1,30
80-20-31-60	Rear Wheel CT250/CT350		71	1,14
19-10-05-05-L	Lifting Rod long CT 350		73	0,78

CT 350 Stückliste/Parts List

19-10-05-06	Lifting Rod short CT 250/CT350		75	0,33
19-10-05-03	Height Control Actuating Rod CT250/CT350		77	0,81
19-10-05-02-C	Height Adjustment Screw CT250/350		79	0,29
61-24-40-46	Height Adjustment Bronze Bearing	CT250/CT350	81	0,08
19-10-05-01	Housing for Height Control CT250/CT350		83	2,03
61-20-63-02	Bearing for Lift Tube CT250/CT350		85	0,09
19-10-02-07	Rear Cover Machine at the Handle	CT250/CT350	87	0,75
61-50-12-60	Eye Screw right turn Lift CT250/CT350		91	0,08
19-10-05-07	Connection for Eyescrew CT 250/CT350		93	0,22
61-50-12-60-L	Eye Srew left turn Lift CT250/CT350		95	74,00
19-10-05-08	Lever with Knob CT 250/CT350		97	0,66
90-21-45-12	Golf Ball CT250/350		99	0,07
90-21-95-50	Level Adjustment Wheel CT250/CT350		101	0,38
90-21-95-51	Revolving Pin for Handwheel CT 350		102	0,08
70-21-26-10	Rubber Grip CT 350		103	0,06
19-10-03-01	Handle with flexible Rubber Block	CT250/350	105	4,00
70-26-18-00	Plate to fasten Rubber Block for Handle	CT250/CT350	107	0,08
70-26-30-00	Vibration blocks CT250/350		109	0,05
19-10-15-02	Belt Cover fixture CT 350		111	0,28
19-10-15-01	Belt Cover CT 350		113	0,00
70-25-02-70	Dusthose at the Machine 70 mm Diameter	Black Colour CT250/CT350	115	0,35
19-10-14-13-E	Lower Bracket for Electric Engine CT 350	Only changeable at CONTEC Factory	150	0,00
19-10-14-13-H	Lower Bracket for Honda Engine CT 350	Only changeable at CONTEC Factory	150	0,00
19-10-19-01	Top Bracket for Electric Motor CT 350	rear	151	1,37
19-10-19-02	Top Bracket for Electric Motor CT 350	Front	152	1,39
56-GX-270-4	Motor 9HP for CT250/CT350		153	0,00
55-03-00-75	Motor 7,5 KVA, 400 Volt CT250/CT350		155	44,00
55-13-00-75	Motor 7,5 KVA, 200 Volt, 3 Phase Japan	CT250/CT350	155	44,00
19-10-09-00	Tube for Drive at Swing Arm CT250/CT350		185	0,00
19-10-14-08	Locating Dowel-Side Plate CT350			0,00
19-10-14-13				0,00
19-10-17-02	Right Bearing Housing Spacer CT 350			0,15
19-10-20-01	Drive Axis CT 250/CT350			0,00
50-20-16-01	Reverse Plug CT250/350			0,00
51-10-10-00	Switch Box For Motor Protective	CT250/350		0,51
51-10-10-19-US	Switch Box For Motor Protective	CT250/350 10 HP 230 Volt US Version		0,00

CT 350 Stückliste/Parts List

51-10-10-20-US	Switch Motor Protective CT250/350	10 HP 230 Volt US Version		0,00
51-10-10-21-US	Motor Protective Switch Button CT250/350	10 HP 230 Volt US Version		0,00
51-20-30-01	Motor Protective 7,5 KVA, 400 Volt	CT 250/350		0,31
51-20-30-03	Low Voltage Protective 400 V CT250/350			0,00
55-03-01-75	Fan for Motor 7,5 KVA, 400 Volt CT250/	CT350		0,00
55-03-02-75	Cover for Fan Motor 7,5 KVA, 400 Volt	CT250/CT350		44,00
56-270-10	Key for Motor 9 HP CT250/CT350			0,00
56-270-11	Starter complete for GX 270 CT250/CT350			0,00
56-270-5	Side Exhaust for Motor CT250/CT350			0,00
70-26-18-50	Rubber Block for Handle CT250/CT350			0,25
95-10-350-42-20	Complete Drum with 48 pcs. Milling	Flails 45/20 CT350		0,00
95-10-350-42-20-M	Complete Drum with 24 pcs. Milling	Flails 45/20 CT350		0,00
95-10-350-A	Axis for Drum CT350			324,00
95-10-350-K	Complete Drum with tipped Tungston Cutter	45/5 CT350		0,00
95-10-350-S	Drum Side Disc with Screws CT350			0,00
95-10-350-T	Drum for CT350			7,90
95-16-24-13	Spacer CT200/350			6,00
95-16-42-10	Milling Flail Cutters 42 / 10 CT200/350			76,00
95-16-42-10-84	Set Milling Flail Cutters 42/10 CT350	1 Set = 84 Pieces		6,40
95-16-42-12	Steel Cutters Beam Flails 42 / 12	CT 200 / CT 350		0,01
95-16-42-20	Milling Flail Cutters 42 / 20 CT200/350			152,00
95-16-42-20-48	Set Milling Flail Cutters 42/20 CT350	1 Set = 48 Pieces		7,30
95-16-45-05	Tungston Carbide Cutters 45 / 5 CT200			38,00
95-16-45-05-212	Set Tungston Carbide Cutters 45/5 CT350	1 Set = 212 Pieces		8,05
95-16-45-06	Tungston Carbide Cutters 45/6 CT200/350			0,00
95-16-45-06-212	Set Tungston Carbide Cutters 45/6 CT350	1 Set = 212 Pieces		0,00